

# STATION AREA

\*AIS DIVI SERIES

## [12] POWERED STATIONS

[12] 5'x5'x42"H L-SHAPED WORKSTATION

ACCESSORIES:

--[1] BOX BOX FILE / EACH

--[1] GROMMET / EACH

## GRADE A,B,C FINISHES:

--LAMINATE: CORPORATE WALNUT

--WS EDGE: CORPORATE WALNUT

--PANEL FABRIC: CAPE COD HARWICH

--PANEL LAMINATE: CORPORATE WALNUT

--PAINT / TRIM: ANTIQUE GOLD

--GLASS: BRONZE

--RACEWAY: LIGHT TONE

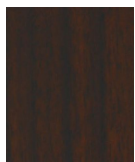

PANEL,  
LAMINATE /  
WS EDGE



PANEL FABRIC

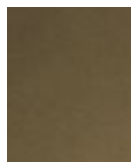

PAINT &  
TRIM



GLASS



RACEWAY

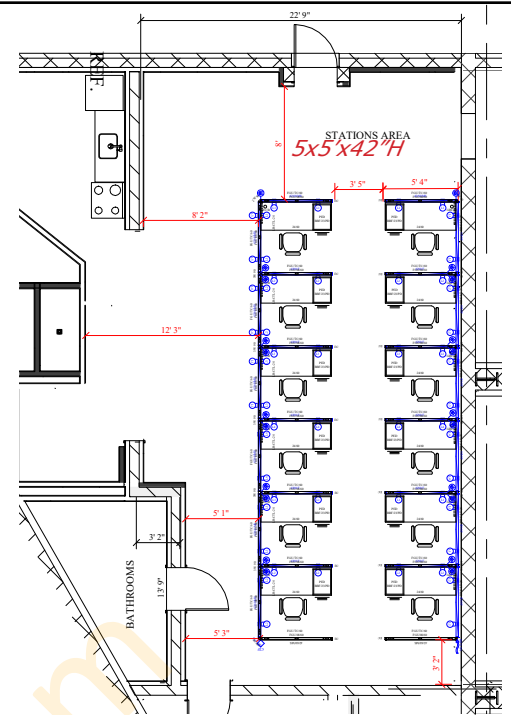

2D LAYOUT

## 3D OVERALL

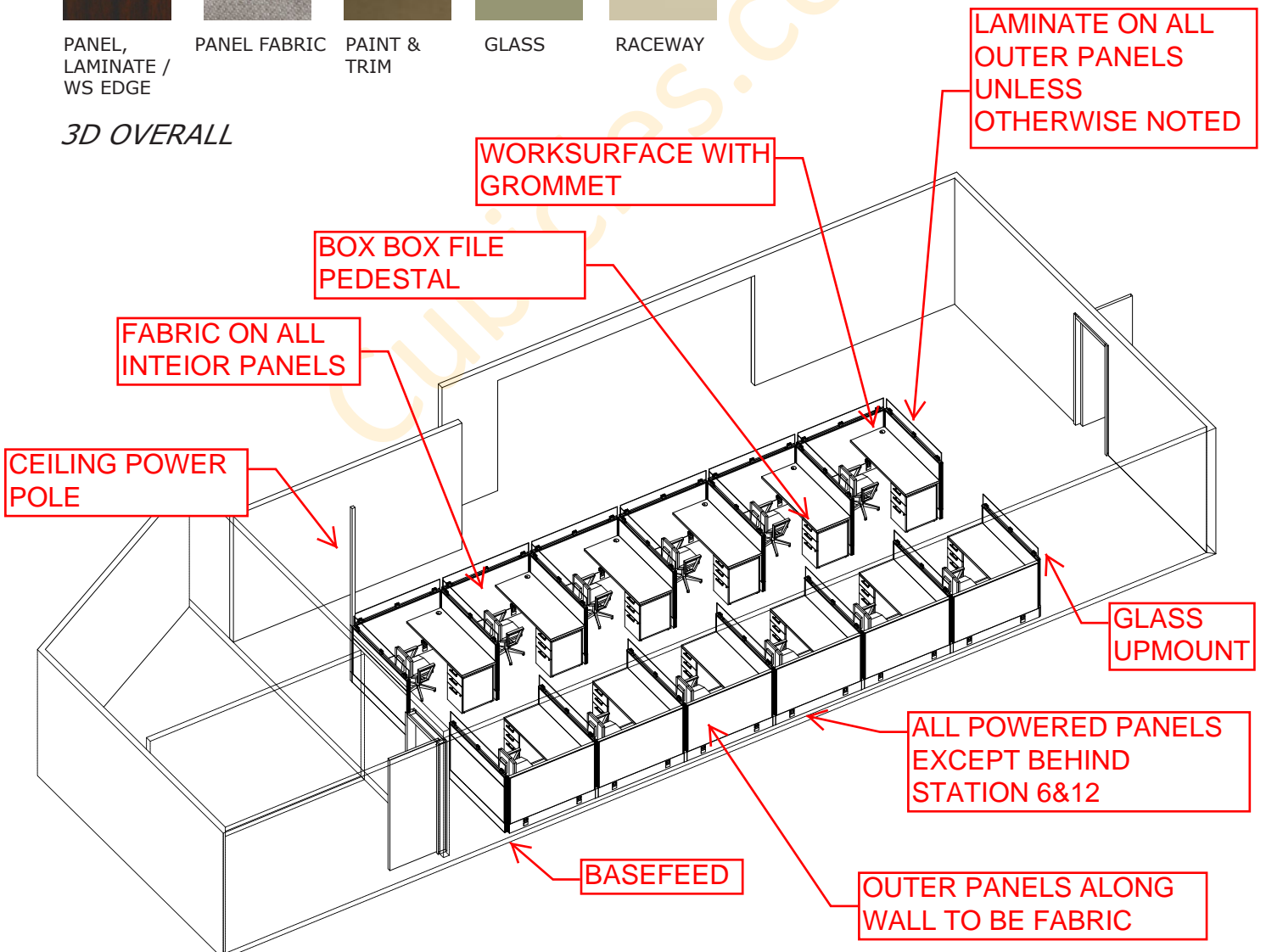

# STATION AREA

\*AIS DIVI SERIES



IMAGE FOR REFERENCE ONLY

\*PLEASE NOTE:\*

42"H FABRIC/ LAMINATE  
PANELS HAVE TO BE  
MONO/ SEGMENTED

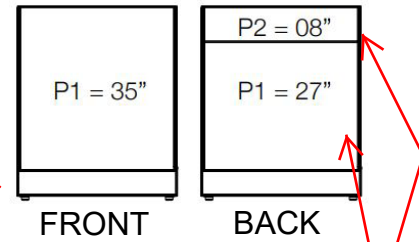

FABRIC SIDE

LAMINATE SIDE

OUTER PANELS TO BE  
LAMINATE UNLESS  
OTHERWISE NOTED

GLASS UPMOUNT

WORKSURFACE  
WITH GROMMET  
IN CORNER

BOX BOX FILE  
PEDESTAL  
[HANDLES PROVIDED  
BY CLIENTS  
DESIGNER]

ALL INTERIOR PANELS  
TO BE FABRIC

ONLY OUTER PANELS  
ALONG WALL TO BE FABRIC  
ON BOTH SIDES

3D DETAIL

