

[illegible]

# CUBICLE AREA - 18 STATIONS TOTAL

## 02 Series Corporate Office Furniture OPEN

### OFFICE AREA

[18] 6X6X39"H POWERED WORKSTATIONS W/ BBF PEDESTAL

AND 14"H FROSTED GLASS MULLION

[3] 3 - DRAWER LATERAL FILES WITH TOP

[3] 5 - DRAWER LATERAL FILES

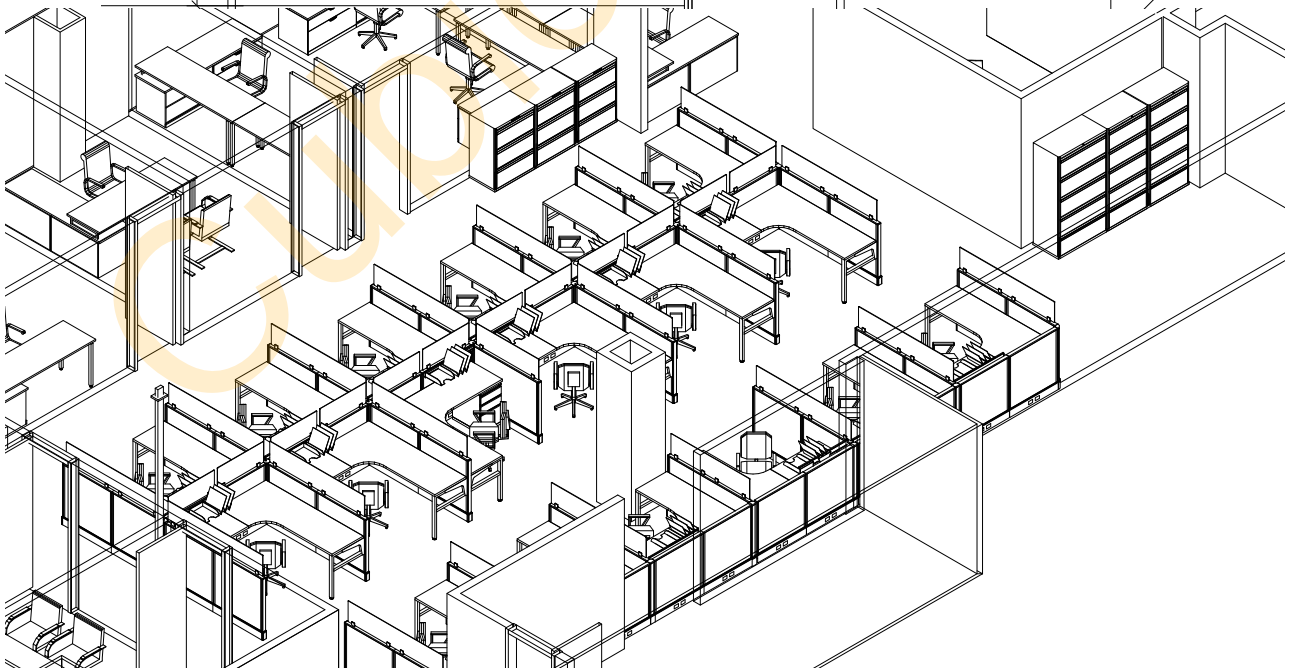
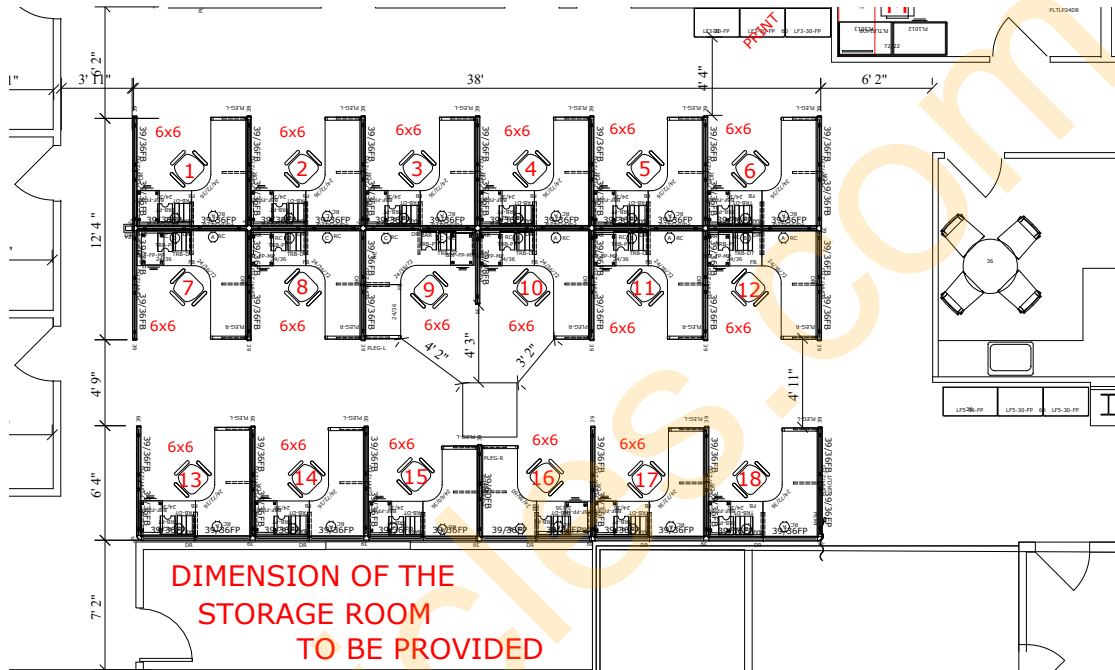

# OFFICES

\*IOF LAMINATE

## OFFICE 1

[1] 6'X6' L-SHAPED DESK

## OFFICE #2

[1] 6'X6' L-SHAPED DESK

[1] 5.5'X6' L-SHAPED DESK

## OFFICE #3

[1] 6'X6' L-SHAPED DESKS

## OFFICE #4

[3] 6'X6' L-SHAPED DESKS

## OFFICE #5

[2] 6'X6' L-SHAPED DESK

[1] 5'6"X6' L-SHAPED DESK

[1] 5'6"X5' L-SHAPED DESK

[1] 4'X2' PRINT STATION

## EXECUTIVE OFFICE

[1] D-TOP SURFACE AND

CHAIRS FROM EXISTING OFFICE

[1] 36" ROUND MEETING TABLE NEW

OFFICE #2 OFFICE #3 OFFICE #4 OFFICE #5

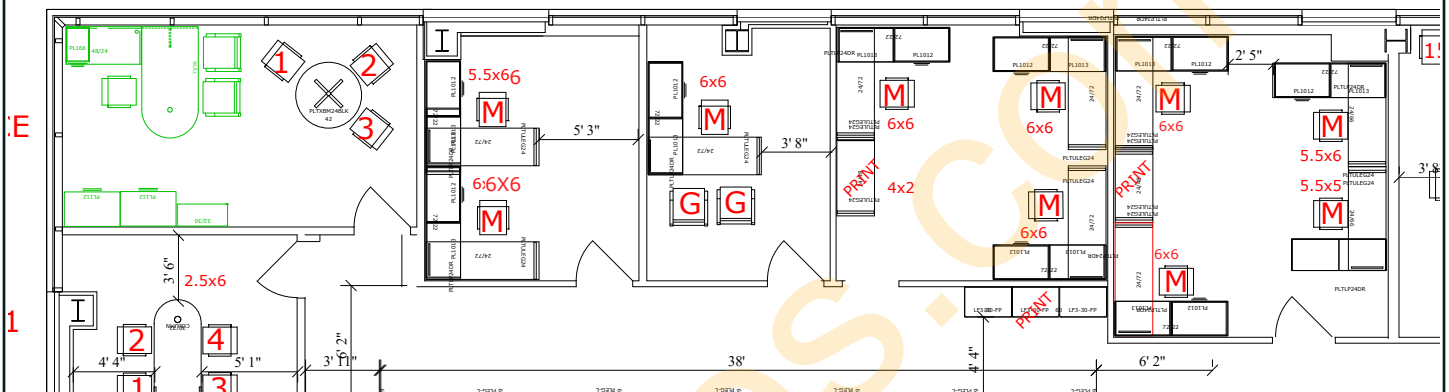

\*IMAGES FOR REFERENCE ONLY. NOT SPECIFIC TO THE PROJECT

# MEETING ROOMS

## \*OPEN PLAN SYSTEM

### MEETING ROOM #1

[1] 6'X2'6" PENINSULA DESK

### MEETING ROOM #2

[1] 6'X2'6" PENINSULA DESK

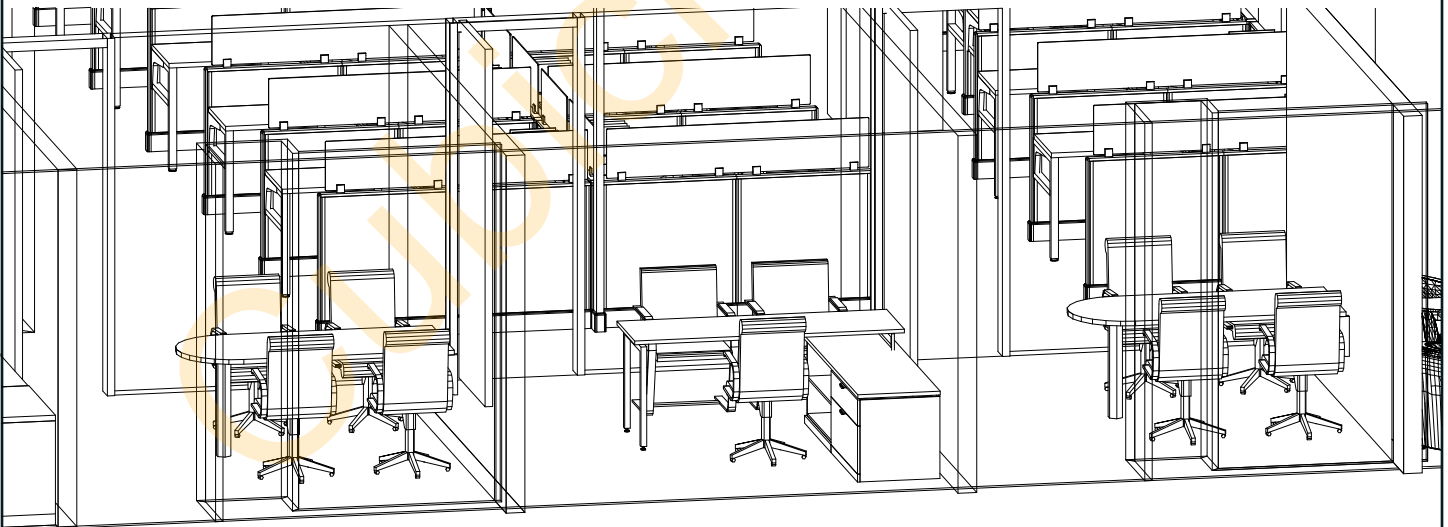
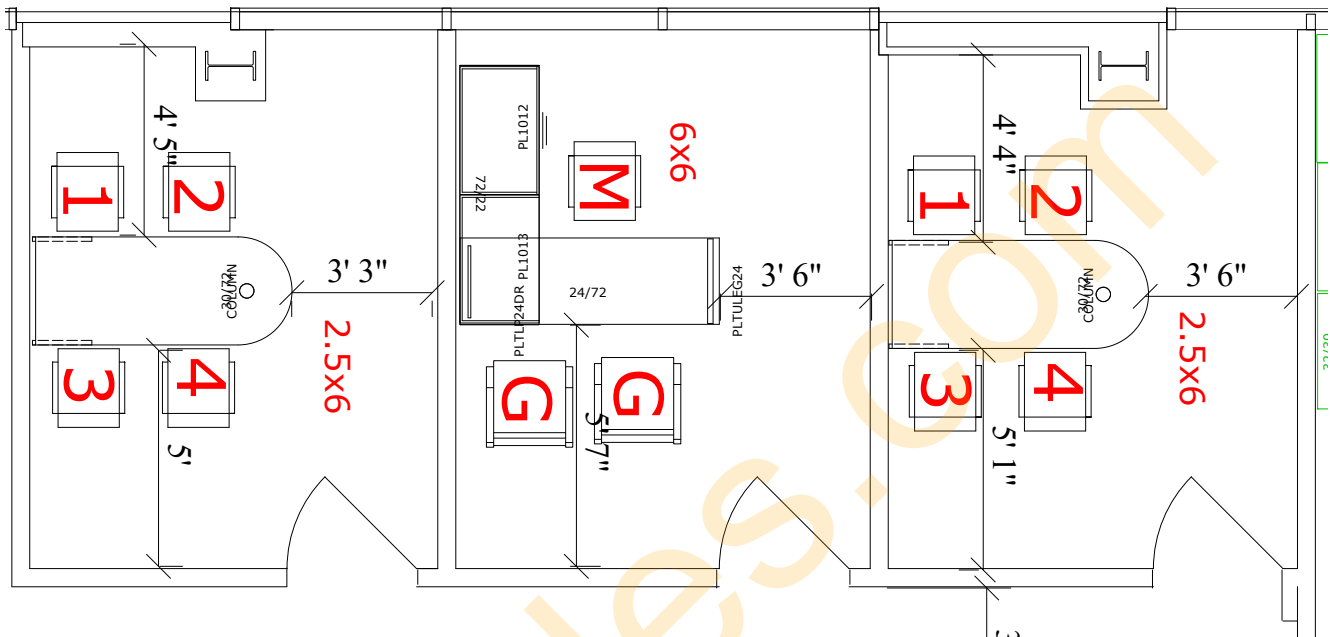

\*IMAGES FOR REFERENCE ONLY. NOT SPECIFIC TO THE PROJECT